



**Set-Up Equipment  
Low Drag Hub Components  
Speciality Products**

## **2020 Featured Product Brochure**

Full 70 Page Catalog Available  
Call or E-mail to Request Yours Today!  
888-399-6074 [sales@drpperformance.com](mailto:sales@drpperformance.com)

# Reduce Rolling Resistance & Increase Performance. Guaranteed!

## Patented *DRP* Hub Defenders™



*DRP* Hub Defender™ adjustable wheel bearing spacers are easy to install and make an immediate difference in how easily the car rolls.

Hub Defenders™ eliminate excessive bearing loads caused by over-tightening spindle nuts and side loads when cornering. Increases free spin by 1200%!

US Patent No. 6,312,162

Available for all popular racing applications:

5x5, Wide Five, Mustang, 2 7/8" Wide Five, GN 5x5 Rear, Mod-Lite, Sprint Car, GM Metric, GM Impala, Camaro, Legends & More.

## *DRP* Premium Low Drag Bearing Kits



We use premium quality bearings and enhance the surface finish to reduce friction by over 25%. Lowers bearing temperatures by up to 120 degrees!

Bearing kits are available for most any application.

Pinion, Carrier and Axle Bearing Kits also available.

## *DRP* Ultra Low Drag Hub Seals



*DRP* ULD hub seals are custom built racing seals that incorporate a full PTFE sealing element and lightweight aluminum housing. Our Air Gap seals have zero drag by creating an air curtain

The lowest drag hub seal we've tested period.

Reusable design lasts through multiple uses.

Available for 5x5, Wide Five, Mustang, GN 5x5 Rear, Bert/Winter's 2 7/8" Wide Five, GM Metric & Legends

## *Ultra Low Drag* Wheel Bearing Grease



This is the best wheel bearing grease we've tested, period. Over 70% increase in free spin verses most popular greases.

Available in 390 gram cartridges, 100 gram mini-cartridges and convenient 50 gram syringes. One syringe will pack approximately 16 bearings 50% full. Do not over-pack wheel bearings. Inject grease to fill cavity between every other roller.

Repack bearings every 1500-2000 laps (750-1000 Miles)

## *Precision* Bearing Packers



Properly packed wheel bearings run cooler and require less maintenance. Our precision bearing packers inject the grease in between the bearing rollers, taking a messy job and making it clean and quick.

Save time while doing the job right!

Precision Bearing Packer uses bearing seats for each specific bearing and full size 390 gram grease cartridges.

Mini Precision Bearing Packers are universal and use mini 100 gram grease cartridges.



**Performance Products**

Complete line of Hub Servicing Tools & Components Available

support@drpperformance.com

Toll Free: 888-399-6074

www.DRPperformance.com

"...let us run with endurance the race that is set before us..." Hebrews 12:1





# Wireless Wheel Scales

Take your set-ups to the next level with our Wireless Pull Down Scale System.



## Benefits:

- Reads Wheel Weights and Shock Travels\* for Increased Accuracy
- Graphs Center of Gravity
- 2200# High Load Scale Pads
- Optional Bump Stop/Sway Bar/Trailing Arm Load Cells/Load Struts

## Features:

- 2200lb Billet Aluminum Scale Pads
- Wireless Touchscreen Control
- Rechargeable Lithium Ion Batteries in Scale Pads and Control

## Measures:

- Wheel Weight
- Shock Position\*
- Bump Stop Load\*\*
- Trailing Arm Load\*\*
- Sway Bar Load\*\*
- Droop Limiter Load\*\*

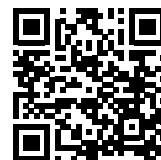

\*Shock Sensors are available separately. Uses same sensors as our data acquisition systems.

\*\*Load Sensors are available separately. Uses same sensors as our data acquisition systems. (4) Total Load Sensor Channels.

**WS22200 \$4160**  
**Financing Available**

888-399-6074  
Support@drppperformance.com  
www.DRPperformance.com



**Satisfaction  
Guaranteed!**

# ***New! DS-X Set-Up System***

**Better handling and faster lap times begin with good, complete set-ups. Our new DS-X Set-Up systems combine our latest pull down technology with our easiest to use system at a price you can't beat.**

- **You Choose What Parts of the System You Want. Add More at Any Time.**
  - **We will Teach You How to Use It. Training is Included.**
  - **Complete Your Set-Ups in Less Time with Higher Quality.**
- **The Only Way This System will Not Make You Fatser is Not to Use It!**

## **Features:**

- Pulls Car Down to Track Height (Accuracy to .005")
- Static Weights
- On-Track Wheel Loads
- Wheel Positions\*
- Binds
- Camber/Caster\*
- Bump Steer, Rear Steer\*
- And More!

## **DSX Pull Down System**

**PD19010A (Asphalt) \$8250. (\$173/mo)**

**PD19010D (Dirt) \$8950 (\$188/mo)**

## **DS-X Master Package**

(Pull Down System & DS-X Scales 1,2 & 3 on following page)

**PD19010AM (Asphalt) \$13,200. (\$278/Mo)**

**PD19010DM (Dirt) \$13,750. (\$289/Mo)**

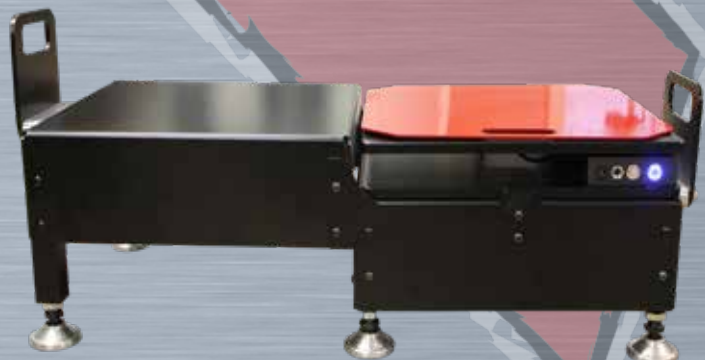

**888-399-6074**

[support@drpperformance.com](mailto:support@drpperformance.com)

[www.DRPperformance.com](http://www.DRPperformance.com)





# ***DS-X Individual Components***

## **1. DS-X Pull Down Stands \$2200**

- Aluminum 10-12" Wheel Stands with Detachable Roll Off Platforms & HD Leveling Feet
- Remote Control (Wired) with Variable Speed Joysticks
- LF, RF, & RR Precision Electric Cylinders (Asphalt Systems)
- RF, RR, & Acceleration Precision Electric Cylinders (Dirt Systems)
- Aluminum 10"-12" Wheel Stands with Detachable Roll Off Platforms & HD Leveling Feet
- Chassis Mount Kit
- Includes Adjustable Floor Mount or Surface Plate Mount Kit (Portable Beam System Optional)
- 1 Day Training at DRP (On-Site Optional)
- Access to DRP Set-Up Analyzer Software
- Access to Private Online Knowledgebase & DS-X Owners Page

## **2. DS-X Scale System with Remote Control \$4750**

- 2200 lb. Single Load Cell Wireless Scales
- Touchscreen Display (Integrated into Pull Down Remote Control)
- (4) Shock Travel Sensor Ports (For Optional Travel Sensors)
- (4) Extra Load Sensor Ports (Bump Stop, Load Strut, Droop Limiter)
- Center of Gravity Graph
- Measures Static Weights
- Measures On-Track Wheel Loads & Balance
- Acceleration Kit (With Dirt Systems) (Measures Forward Drive, Dynamic Bite)
- Checks for Binds
- Test Set-Up Changes

## **3. DS-X Pull Down Cylinder & Mount Kit \$5850 (Asphalt) \$6450 (Dirt)**

- RF, LF, RR Cylinder (Asphalt Systems)
- RF, RR Acceleration (Dirt Systems)
- Chassis Mounts
- Adjustable Floor Mount Kit
- Control Cabinet with Power Supply and Cables

## **4. Optional RS400PRO Wheel Alignment System \$3600**

- Four Wheel Laser Alignment System
- Measures Wheel Position at Contact Patch
- Quickly Read Static and Dynamic Measurements
- Measures Toe, Rear Steer, Contact Patch Alignment, Wheel Base, Ackerman, Bump Steer
- Measures Camber and Dynamic Caster (Without Sweeping Wheels)

## **5. Optional Ground Plane/Ride Height Laser Upgrade \$525**

- Self-Leveling Ground Plane Laser
- Height Adjustable
- Includes (4) Magentic Ride Height Rulers

## **6. Additional Options**

- On-Site Training (Add \$1000 + Travel Expenses)
- Shock Position Sensor Kit \$1385
- Height Extension Kit (6", 8", or 10") \$575
- Portable Beam Kit \$2800
- 4500# Dual Load Cell Upgrade \$650
- Dual Axis Caster/Camber Gauges \$243
- Slip Plates (Not Included in Above Kits) \$265

# DRP DSS-3 Set-Up System

The DRP DSS-3 Set-Up System sets the standard for short track race car set-up. Set your race car up as it races on the track with accuracy. Wireless scales with shock travel sensors, wheel load graphing, data downloading plus lots more!



## Full Chassis Loading with Integrated High Load Scales & Billet Aluminum Wheel Stands

Load all four tires, springs, bump stops, sway bar, etc., to full track load. Make an adjustment and see the difference.

## Measure On-Track Balance with Precision Joystick Controls on a Handheld Remote - New for 2020!

Achieve complete vehicle positioning to +/- .005". Repeat the same test over and over to find suspension binds. Optimize balance based on your specific track/driver combination.

## Find Out What You're Missing

Graph individual wheel loads to optimize bump stop and sway bar timing. Optimize critical set-up inputs such as camber and rear steer. Get the load out of the track and into the tires!

## More than Just Pulling the Car Down

Our analysis software gives you a complete look at your set-up. The virtual engineer gives you set-up suggestions allowing you to fine tune your set-up before getting to the track!

### Measures/Features:

- Vehicle Balance
- Wheel Positions\*
- Shock Travels\*
- Binds
- On-Track Ground Clearance
- Camber/Caster\*
- Bump Steer
- Rear Steer
- Sway Bar Load\*
- Droop Limiter Load\*
- Bump Stop Loads\*
- Dual Load Cell 4500# Scales
- Wireless Scales with Touch-screen Display
- Precision Joystick Control on Handheld Remote



888-399-6074

support@drppperformance.com  
www.DRPperformance.com

**PD19013A 2020 DSS-3 Asphalt System \$18,500 (\$377/mo)**

**PD19013D 2020 DSS-3 Dirt System \$19,450 (\$397/mo)**

**Master Packages Include Pull Down System, Scales, RS400PRO & Ground Plane Laser**

**PD19013AM 2020 DSS-3 Asphalt "Master" Package \$22,450 (\$472/mo)**

**PD19013DM 2020 DSS-3 Dirt "Master" Package \$23,350 (\$496/mo)**



Financing Available  
5 Year Warranty on Fixtures  
2 Year Warranty on Electronics  
Satisfaction Guaranteed



# DRP DSS-4 Set-Up System

The DRP DSS-4 Set-Up System is the choice for professional teams and set-up shops who value speed and accuracy. Quickly test set-ups or replay an entire lap for the ultimate in suspension analysis.



## Easy to Use & Fast!

A Fully Automated System. Enter the desired shock travel or wheel load and the DSS-4 will take the vehicle to that position automatically, while recording wheel loads, shock travel, cross, balance and more, in **30 seconds or less!** Replay an entire lap in slow motion and find problems you've never seen before.

## The Ultimate in Repeatability.

Achieve complete vehicle positioning to  $\pm .005"$ . Repeat the same test over and over to find suspension binds.

## The Data You Need Instantly

View wheel load graphs, bump stop load graphs, sway bar (or droop limiter or trailing arm..) load, all while the test is running. Make decisions quickly with confidence.

**PD19014A 2020 DSS-4 Asphalt System \$38,900 (\$819/mo)**

**PD19014D 2020 DSS-4 Dirt System \$38,900 (\$819/mo)**

**Master Packages Include Pull Down System, Scales, RS400PRO & Ground Plane Laser**

**PD19014AM 2020 DSS-4 Asphalt "Master" Package \$43,900 (\$924/mo)**

**PD19014DM 2020 DSS-4 Dirt "Master" Package \$43,900 (\$924/mo)**



## Measures:

- Vehicle Balance
- Wheel Positions
- Bump Stop Loads & Timing
- Sway Bar Load/Timing
- Droop Limiter Load/Timing
- On-Track Ground Clearance
- Camber/Caster
- Bump Steer
- Rear Steer
- Dynamic Cross %
- Forward Drive
- Dynamic Bite
- And more!



888-399-6074  
support@drpperformance.com  
www.DRPperformance.com

# Real Square Alignment Systems

Real Square Alignment Systems use laser lines and precision machined fixtures to quickly and accurately measure wheel position. Take over 20 measurements in 30 minutes. Find problems fast and make adjustments more accurately and quickly than ever before. Once you use this system, you will not want to do wheel alignment any other way.

## 5 Reasons Why You Should Be Using A Real Square Alignment System

- 1. Saves Time** - 15-20 minutes set-up time and you're reading the position (toe & camber) of all four wheels. A complete alignment can be done in as little as 30 minutes!
- 2. Increases Accuracy** - Eliminates common alignment variables that lead to inaccuracy.
- 3. Takes More Measurements** - Take over 20 measurements easily and quickly.
- 4. You'll Do It More Often** - With your alignment process being faster, you'll do it more often resulting in more accurate and more repeatable results!
- 5. Find Problems Faster** - Seeing all of your measurements allows you to find problems and solutions even faster.



### Measures:

- Toe x 4
- Camber x 4
- Wheel Base x 2
- Contact Patch Alignment x 2
- Rear End Squareness
- Rear End Lateral Position
- Axle Tube Straightness
- Bump Steer x 2
- Rear Steer
- Ackerman

- Check Individual Wheel Toe
- Measure Bump Steer in Minutes, Not Hours
- Repeatable Measurements
- Make Suspension Adjustments and See The Change Instantly
- No Tape Measures!
- Available for All Types of Hubs and Chassis
- Works Statically and Dynamically

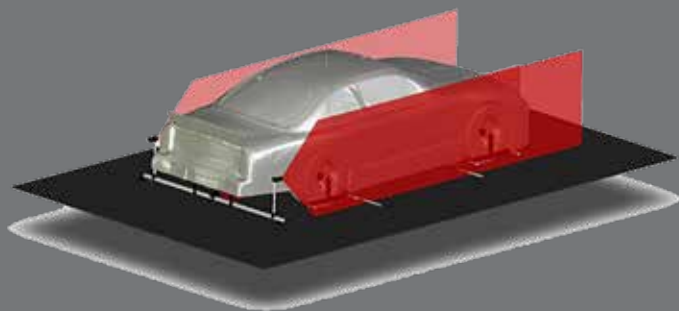



## RS200

### Two Wheel/Single Laser Alignment System

\$1875

- Easily Portable/Trackside System
- Laser Stand Quickly Clamps to Chassis
- System Can be Moved From Right to Left or Front to Rear
- Wheel Fixtures Can be Used as Super Accurate Toe Plates
- Works with Most Chassis Types

#### System Includes:

- (2) Axle Alignment Fixtures
- (2) Wheel Measurement Fixtures
- (2) Frame Squares
- (1) Single Laser Stand
- (1) Adjustable Laser Assembly
- (1) Caster Camber Gauge Adapter
- (1) Laser
- Tools & Instructions

**REAL SQUARE**   
Laser Wheel Alignment Systems

Great System for Any Level Team!

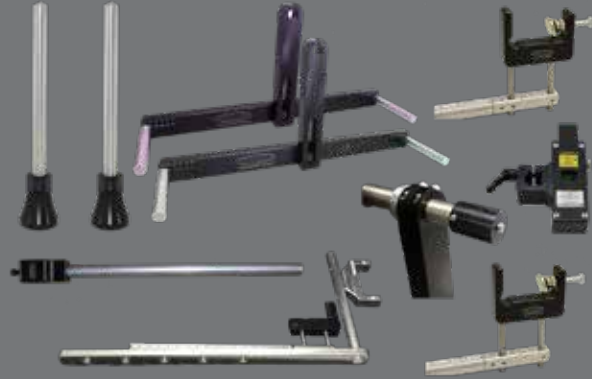

## RS200PRO

### Two Wheel/Dual Laser Alignment System

\$2780

- Same System as RS400PRO, with 2 Wheel Fixtures Instead of 4
- Wheel Fixtures Can Be Moved to Measure All Four Wheel Positions.
- Works with Most Chassis Types

Easily Upgrades to RS400PRO!

#### System Includes:

- (2) Axle Alignment Fixtures
- (2) Wheel Measurement Fixtures
- (2) Frame Squares
- (1) Dual Laser Stand
- (2) Adjustable Laser Assembly
- (1) Caster/Camber Gauge Adapter
- (2) Lasers
- Tools & Instructions



## RS400PRO

### Four Wheel/Dual Laser Alignment System

\$3600\*

- Industry Standard System
- Read All Four Wheel Positions
- Static & Dynamic Measurements
- Works with Most Chassis Types

#### System Includes:

- (4) Axle Alignment Fixtures
- (2) Rear Dust Cap Adapters
- (4) Wheel Measurement Fixtures
- (2) Frame Squares
- (1) Dual Laser Stand
- (2) Adjustable Laser Assembly
- (1) Caster/Camber Gauge Adapter
- (2) Lasers
- (2) Wall Mount Storage Racks
- Tools & Instructions

\*Price May Vary Depending on Chassis



# DRP 4 Channel/2 Sensor WiFi Data Acquisition System

- **Wireless Downloading!**

Download your data without leaving the trailer!

- **All Sensors Sink Together**
- **Track Maps Shows Exactly Where Car is On Track**
- **Improve Driver Performance**
  - **Faster Troubleshooting**
  - **Better Chassis Tuning**
  - **Accurate Shock Tuning**
    - **Fast Installation**
- **Upgradeable! Add up to 32 total sensors with expansion modules.**



## System Includes:

- Aim EVO-5 Wifi Data Logger with Mount
- (2) String Style Shock Sensors with Mounts
- (2) Open Channels
- Software & Instructions
- (1) RPM Cable
- (1) GPS Module (For Lap Times & Track Position)
- Video Training Course
- Fully Configured, Plug & Play System
- Fast Installation & Removal
- WiFi Data Downloading
- SD card for Data Storage
- 12 Months Standard Phone & Email Support

**DA21310 \$2950.**

## Popular Options:

- Additional Shock Position Sensor \$369.
- Additional 4 Channel Expansion Harness \$355.
- Additional Sensor Cable \$42.

888-399-6074

Support@drpperformance.com  
drpperformance.com



**Performance Products**



Stop Guessing Travels and Start Taking Measurements!

## What Can You Measure?

Shock Travel • Shock Speed  
Steering & Throttle Position  
Brake Pressure • Spring Loads  
Tire Temperatures • RPM  
Wheel Speed • Lateral Grip  
Trailing Arm Loads & More!

**Contact us for a detailed quote or additional information.**



# DRP 8 Channel PRO WiFi Data Acquisition System

## **Asphalt System** Includes:

- Aim EVO-5 Data Logger with Mount
  - (4) String Style Shock Sensors with Mounts
  - (1) String Style Steering Sensor with Rack Mount and Cable, String Style Throttle Sensor with Cable
  - (3) Open Channels, Software, & Instructions
  - Video Training Course
  - Fully Configured, Plug & Play System
  - Fast Installation & Removal
  - WiFi Data Downloading with Built-in SD card
- DA21400A \$4,650

## **Dirt System** Includes:

- Aim EVO-5 Data Logger with Mount
  - (4) String Style Shock Sensors with Mounts
  - (1) 5th Coil/Pull Par String Style Travel Sensor with Mounts and Cable
  - (1) String Style Steering Sensor with Rack Mount and Cable, String Style Throttle Sensor with Cable
  - (2) Open Channels, Software, & Instructions
  - Video Training Course
  - Fully Configured, Plug & Play System
  - Fast Installation & Removal
  - WiFi Data Downloading with Built-in SD card
- DA21400D \$4,950

Stop Guessing Travels and  
Start Taking Measurements!

### **What Can You Measure?**

Shock Travel • Shock Speed  
Steering & Throttle Position  
Brake Pressure • Spring Loads  
Tire Temperatures • RPM  
Wheel Speed • Lateral Grip  
Trailing Arm Loads & More!



- More Information with Real Measurements
- Improved Driver Performance
- Faster Troubleshooting & Better Tuning Allowing For Faster and Easier Chassis Set-Up



888-399-6074

Support@drppperformance.com  
drppperformance.com





# Data Acquisition Accessories

This is just a sampling of our data sensors and accessories. Check out our full line catalog or website!

## Shock Sensor Mount Kit

Includes: (8) Slip-On Pot Mounts, (4) Pot Mount Extensions, (4) Clamp-On Pot Mounts\*, (1) Hardware & Spacer Kit

**Standard - DA21622 \$239**

**Deluxe - DA21625 \$329**

\*Deluxe Kit Only



## Bump Stop Load Cell

- Includes: (1) Load Cell, Cable, & Caps
- 2" OD x 0.625" ID
- 4000 lbs., inline amplified



**DA21751 \$1249**

## Sway Bar Load Cell

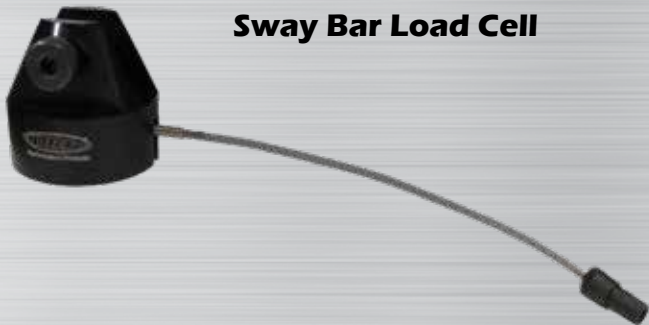

- Large diameter REM finished dome eliminates binds
- Slapper style
- 4000 lb. capacity
- Includes spacer to replace load cell

**\$1495**

## String Shock Sensor

- 4" to 25" travel range
- Simple mounting with mounts included
- String allows for maximum clearance in tight spaces
- Heavy duty, durable sensors



**DA21607 \$389**

## Tire Temperature Sensor Kit



- Non-contact sensor
- 1 sensor gives 4 temperatures across the tire
- Includes sensor configuration file
- Digital sensor doesn't take up analog channels

**DA21690 \$3600**

## MXG 1.2 Strada Dash



A high end, yet affordable digital dash for your racecar. Works with most of our standard sensors. User configurable so you can view the data you want to see.

**DA21270 \$1399**



# Ground Plane Laser Kit



Ground Plane Laser Kit - PD21801 \$525



- Level Scales & Measure Ride Height
- Self-Leveling Laser
- Heavy Duty Adjustable Height Laser Stand
- Magnetic Frame Height Rulers

## Slip Plates

- Lightweight Aluminum
- Sheet PTFE
- No Grease, No Mess!
- Durable & Clean



4 Slip Plates, 4 PTFE Sheets - 007 90301A \$265  
PTFE Sheet - 007 90306 \$28



## Wheel Plates

- Fully Stagger Adjustable
- More Consistent Measurements
- Flat Bottom with Built-in Slip Plate
- 15° Camber +/-

Wide Five - 007 95010 \$299

5x5 - 007 95015 \$299

Legends - 007 95020 \$249

5x5 Wheel Plate Adapter -  
007 95012 \$49 (Adapts Wide  
Five Wheel Plate to 5x5 Hubs)





# Triple Probe Memory Tire Pyrometer

Reduce the amount of time taking tire temperatures by 66% by taking all 3 temperatures at once! This easy to use tool can be used by right or left handed crew members. Available for 8", 10" and 15" tires.

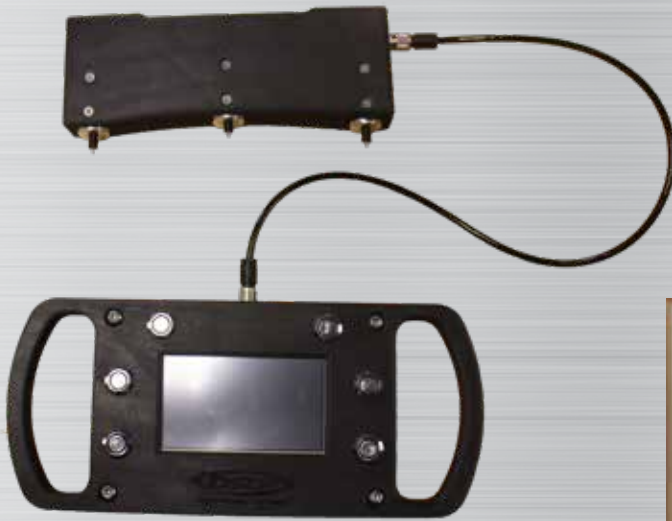

- Displays Average & Split for Each Tire
- LCD Color Display
- Stores 10 Sets of Temperatures for Quick Review
- Durable, yet Lightweight Composite Carbon Housing
- 1 Button Push = Inside, Middle & Outer Temps
- Fixed Probes = More Consistent Readings

8" Tire - TP17008 \$699  
10" Tire - TP17000 \$699  
15" Tire - TP17015 \$749



Developed by: Lazy J Engineering

## Digital Wireless Brake Bias Gauge

DRP's Digital Wireless Brake Bias Gauge is the best way to acquire brake bias and brake pressure timing without using a data acquisition system. This Brake Bias Gauge is a data logger that graphs front and rear (or left and right) pressure gain in the shop and on the track. Pressure sensors plug right into the transmitter and the display and receiver are wireless. Available with or without sensors.

- Wireless Touchscreen Display
- Displays Front & Rear Brake Pressures and Brake Bias
- Recording Function Graphs Brake Pressure Real Time
- Records and Graphs on Track Pressures
- No Computer Necessary!
- Download to USB Drive for More Advanced Analysis

Digital Wireless Brake Bias Gauge With Sensors - WP12100 \$1175

Digital Wireless Brake Bias Gauge Without Sensors - WP12000 \$750



888-399-6074

[www.drpperformance.com](http://www.drpperformance.com)

[Support@drpperformance.com](mailto:Support@drpperformance.com)



# Precision Rear End Housing Fixture

- Checks Axle Tubes and Side Bell for Straightness
- Straightens Bent Tube Axles
- Sets Toe and Camber in Axle Tubes

Includes:

- Fixture
- (2) Hub Measurement Plates (Wide Five Pattern)
- Choice of Tape Measures or Digital Gauge

**Quick Change or 9" Ford with Tape Measures \$1850**

**Quick Change or 9" Ford with Digital Gauge \$2450**

\*Adapter Plates for 5x5 Hubs Available



## Spindle Fixture

- Measure Spindle Height, Drop, Pin Angle, Pin Offset, and Steering Arm Location
- Compare, Repair, and Build Spindles
- Compares Spindles and Checks for Bends

Check, repair, and build new spindles on one fixture! This fixture will allow you to check purchased spindles, develop new combinations, and build custom spindles all in house. Heavy duty, yet fully adjustable fixture for both fabricated and forged spindles.

**Wide Five & 2" 5x5 Front Spindles \$1350**

Also available for GM, Ford, GN & 2 7/8" Wide Five & custom applications.

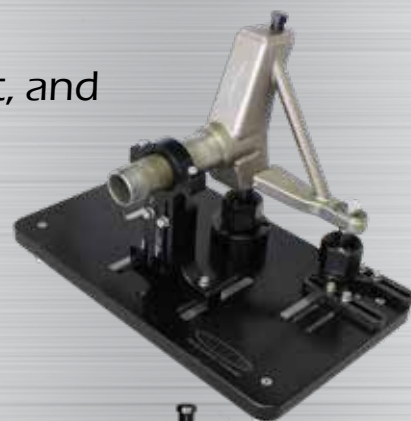



# Hub Defender™ Low Drag Kits

The one stop kit to eliminate drag! Save time and simplify ordering with DRP Low Drag Hub Defender™ Kits. Complete with one Hub Defender™, one Ultra Low Drag Bearing Kit, and one Ultra Low Drag Seal this is the perfect combination of speed. Also available with Zero Drag Air Gap Seals.



- Best low drag components in one kit
- Multiple applications available
- Simplifies ordering

Kits available for:

- Wide Five
- 2" 5x5
- 2 7/8" Wide Five Front & Rear
- GM & Ford
- Coleman Pro-Lite
- Legends Front (Ask about our Super Kit!)
- And more!



888-399-6074  
support@drppperformance.com  
www.DRPperformance.com



Hub Kits starting at \$108.70





# Hub Defenders™

Our flagship low drag hub product. Covered by **US Patent Number 6,312,162**, the DRP Hub Defender increases wheel spin by up to **1200%** by reducing friction from overloaded bearings and eliminating tire drag from unwanted toe due to bearing end play.

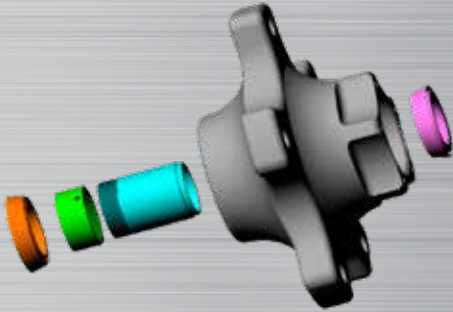

- Increases hub free spin
- Increases corner speed
- Reduces drag
- Adjustable to precisely fit each hub
- Lowers bearing temperatures

We make Hub Defenders™ for most racing hubs, but we can also customize it to your exact specifications and measurements. Visit us online at [drppperformance.net/hub-components](http://drppperformance.net/hub-components) for more information and a downloadable version of our custom Hub Defender form.



Available for almost any application:

- Wide Five
- 2" 5x5
- 1 Ton/ 1 1/2 Ton Wide Five
- GM Metric & Impala
- Sprint Cars
- Mustang/Pinto
- Drag Race
- And more!



888-399-6074  
[support@drppperformance.com](mailto:support@drppperformance.com)  
[www.DRPperformance.com](http://www.DRPperformance.com)



Spacers starting at \$29.00





# Premium Low Drag Bearing Kits

We take the highest quality bearings and put them through a 6+ hour process to smooth the bearing surface and etch it with a microscopic pattern to retain the grease. Metal surfaces contain peaks and valleys that when rubbed together can cause friction and drag, slowing you down. Our Premium Super finishing processes smooths the surface and lowers temperatures in hubs, engines, rear ends, and transmissions.



- Lowers rolling resistance
- Reduces friction & drag
- Lowers temperatures
- Increases free hub spin
- Available for Almost Any Application



With DRP Premium Bearing Kits you can reduce your bearing temperatures by over 100 degrees in comparison to stock bearings! You can also increase free spin by over 250%!

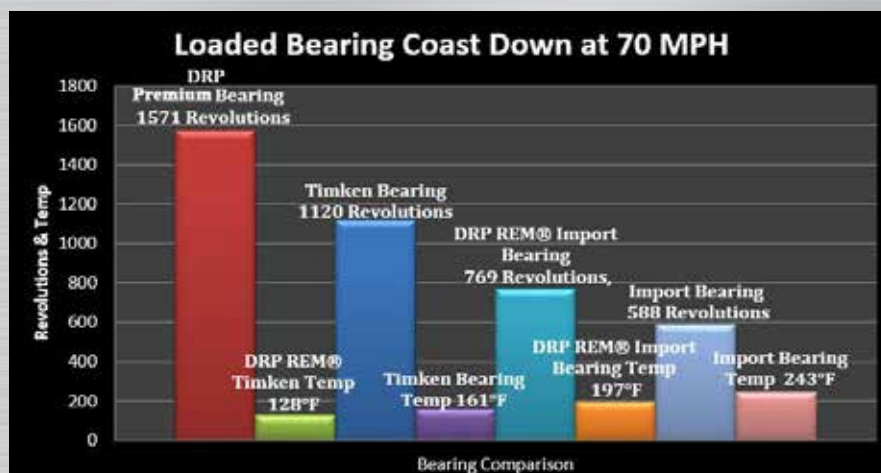

888-399-6074  
support@drppperformance.com  
www.DRPperformance.com



Bearing Kits starting at \$38.00  
Races & Rear End  
Bearings also  
available.





# Ultra Low Drag Hub Seals



DRP Ultra Low Drag Hub Seals are premium quality, USA made, full PTFE lip seals. Built with a lightweight aluminum housing, these are the lowest friction seals we have tested. They provide a true seal to prevent debris from getting to the hub bearings and are less than 1 in/lb resistance per seal. They are also reusable when removed properly!



DRP offers two types of low drag seals. We carry our standard ultra low drag seal, along with a zero drag air gap seal. Air gap seals are not recommended for dirt track applications or applications exposed to moisture.

## Ultra Low Drag PTFE Seals

- Good for All Applications
- Lightweight aluminum housing
- Full PTFE lip (no coatings)
- Provides a Full Seal
- Reduces drag and rotating weight
- Reusable
- Works on aluminum or steel tubes
- Increases hub free spin
- Lower Maintenance

## Zero Drag Air Gap Seals

- Best for Asphalt/Professional Applications
- Lightweight aluminum housing
- Air gap creates protective air curtain
- Zero Drag!
- Directional (Right Side or Left Side)
- Reusable
- Works on aluminum or steel tubes
- Increases hub free spin
- Custom Applications Available

Available for:

- Wide Five
- 2" 5x5
- Cup Style (Speedway)
- 2 7/8" Wide Five
- GN 2.5" 5x5 Rear
- Mustang II Front
- GM
- Drag Race
- Legends
- And more!



888-399-6074

support@drpperformance.com  
www.DRPperformance.com



Seals starting at \$24.00





# Precision Bearing Packers

Our Precision Bearing Packers make for a mess free, easy way to pack bearings. Accurately inject the appropriate amount of grease between bearing rollers for an entire set of 8 hub bearings packed in under 10 minutes with no mess!

- Saves time
- Prevents Grease Contamination
- Lower bearing temperatures
- Made in the U.S.A.

## **Mini-Precision Bearing Packer \$79.85**

- Uses Mini 100 gram Cartridges
- Universal for Any Bearing
- Small Size Stores Easily



## **Precision Bearing Packer \$199\***

- Uses Standard 390 gram Cartridges
- Includes Bearing Seats Specific to the Bearing
- Can be used without seats on any bearing

\*Starting Price

We also offer replacement needles for the bearing packer, along with just the base, the base and gun, and just the seats. Check it out online at [store.drppperformance.com/bearing-packers/](http://store.drppperformance.com/bearing-packers/)



**See our Full Line Catalog or Web-Site for Specific Applications**



Overpacked bearings cause excessive temperature and hub pressure build-up. Make sure to only pack your bearings about 50% full. Proper bearing packing reduces maintenance and increases bearing life. Bearings should be repacked every 1,500 to 2,000 laps.

888-399-6074  
[support@drppperformance.com](mailto:support@drppperformance.com)  
[www.DRPperformance.com](http://www.DRPperformance.com)





# Ultra Low Drag Bearing Grease

We can't have great great hub bearings packed with sub par grease. We've tested dozens of the most popular greases on the market and found Kluber Lubrication to be the unquestionable best for high performance applications.

Our engineering team worked with the enineers at Kluber to determine the optimum formula for short track applications.

\*If you have another application, call us and we may reccommend another formulation.



007 10756 50g Syringe, \$39.90  
Packs Approximately 16 Bearings

- Lowers Friction & Drag
- 70% Increase in Free Spin vs. Next Best Grease!
- For High Speed Bearings Only!  
Not for use in ball joints, u-joints, etc.



007 10753 100g Cartridge, \$65.00  
Packs Approximately 32 Bearings

We reccommend packing wheel bearings no more than 50% full (every other roller).

Re-pack bearings every 1500-2000 laps (750-1000 miles).



007 10750 390g Cartridge, \$159.90  
Packs Approximately 125 Bearings

888-399-6074  
support@drppperformance.com  
www.DRPperformance.com





# Scalloped Aluminum Tubes



The original and  
best scalloped  
aluminum tube!

Bulk pricing available!

Great For:

- Tie Rod Sleeves • Trailing Arms • Control Arms
- Chassis Struts • Track Bars • Throttle Rods
- Body Braces • Shift Linkage • Radiator Mounts

Available in 1/4", 3/8", 1/2", 5/8", and 3/4" thread sizes and lengths from 3"-60" with custom lengths and colors also available.



## Scalloped Tubes

We designed this tube to reduce flex and save weight back in 2008. It's become the industry standard. Available in all diameters and in 1/4" increments. Custom tubes, threads and lengths available. Black and silver are standard, custom colors available.



## Clamp Style Tubes

Clamp style suspension tubes save time when making suspension adjustments. Our clamp tubes have no snap rings and use your choice of a 1/4" socket head or 12 point for tight clamping. Available in 5/8" and 3/4" thread sizes. Black anodized only.



## Lightweight Style Tubes

Lightweight style tubes have extra material machined off to save weight and look great. Available in 1/2", 5/8", and 3/4" thread sizes. Black anodized only.



888-399-6074  
support@drppperformance.com  
www.DRPperformance.com



Check out a complete  
listing in our full line  
catalog or online!



# DRP Set-Up Tools

This is just a sampling of our set-up tools and accessories. Check out our full line catalog or website!

## Shock Travel Indicator



- Quickly measure shock center to center
- Compression & extension travel indicator
- Mounts easily to bolt heads



\$99

## Steering Lock Kit for Sweet Power Racks



- Center and lock the steering shaft
- Helps with accuracy and repeatability for chassis set-up

\$27

## Centerline Tool



- Quickly center or "X" the steering
- Measure Shock or Suspension Link Centerline
- Increase set-up accuracy
- Adjusts from 16"-31"

\$74

## Set-Up Struts



### Standard Struts

- Replace shocks & springs for precision set-up work
- Made using scalloped tubes for durability & easy adjustments
- Fits all standard 1/2" mounts

\$44

### Quick Adjust Struts

- Replace shocks & springs for precision set-up work
- Easily make adjustments 1/4" at a time with quick pin
- Length is laser etched into side, no tape measures needed!

\$149

## Magnetic Wheel Base Tool

- Quickly measure wheel base with 1 person
- Uses standard tape measure & shafts from Real Square wheel alignment fixtures



\$44

## Dual Axis Dynamic Caster Camber Gauge



- Reads caster and camber simultaneously when chassis or suspension is in motion
- Tracks Caster Change without turning wheel
- Does not measure Static Caster

\$199

888-399-6074

support@drppperformance.com

www.DRPperformance.com





# Low Drag Rod Ends

After years of testing and improving wheel bearings, we've done the same with rod ends! Stock rod ends can have 60 ft lbs or more of resistance under load. We take quality rod ends, improve the surface finish and then coat them with a dirt repellant lubricant. An incredible difference.

- Reduce torque by up to 40 ft./lbs.
- No lube required
- Dirt Repellant

## Sizes Available:

- 1/4"
- 3/8"
- 1/2"
- 5/8"
- 3/4"



## Seal Driver

- Install seals quickly and easily
- Avoid damaging and wasting seals (and money!)
- Multiple applications available



Available for most popular applications.



Starting at \$44

## Seal Remover

- Remove seals to be reused without damaging them - saving you time & money!
- Removes seals quickly and easily



Available for:

- Wide Five
- 2" 5x5



\$44



# Hub End Play Gauge

Our hub end play gauges are the quickest way to accurately set-up bearing spacers. This tool screws onto your spindle and reads hub end play to .0005". Once end play measurement is obtained, simply adjust the spacer to the desired end play or pre-load and set the spacer lock. Arm, indicator, and shaft are universal, simply swap the spindle adapter for different applications.

- Most accurate and quickest way to set and measure bearing pre-load
- Use on multiple applications (with appropriate spindle adapter)

Available for:

- Wide Five
- 2" 5x5
- 2 7/8" Wide Five
- 2.5" GN Rear
- Mustange/Pinto Front
- And more!

End Play Gauges starting at \$129.00



## Hub Set-Up Service

DRP is happy to offer low drag hub set-up service. We take your hubs and return them in "race ready" condition. Spacer is set, bearings are packed, seal is installed. Starting at \$30 per hub. New bearing and race installation along with complete hub assemblies also available.

Service Includes:

- Hub Measuring & Inspection
- Bearing Spacer Set-Up
- Bearing Inspection
- Bearing Packing
- Seal Installation

Also Available:

- New Bearing Installation
- New Race Installation



**Performance Products**

888-399-6074

[support@drppperformance.com](mailto:support@drppperformance.com)

[www.DRPPperformance.com](http://www.DRPPperformance.com)



# Commercial Hub Defenders™

***Improves Fuel Mileage  
Lowers Maintenance  
Reduces Failures***



- **Reduce Bearing Drag Caused by Bearing Preload**

Bearing preload causes tremendous drag on your hubs, robbing your vehicle of horsepower and fuel economy.

- **Reduce Tire Drag & Wear**

Bearing end play fixes the preload problems, but causes steering instability and tire scrub, increasing tire wear and drag. Our Hub Defenders™ allow you to set your hub bearings to the perfect balance of zero pre-load and .001" end play.

- **Reduce Maintenance Costs Caused By Bearing Failure**

Bearing preload and excessive end play causes bearing and seal failures. Our Hub Defenders™ run cooler and lessen maintenance.



Available for:

- Enclosed Trailers
- RV's
- Camper Trailers
- Tow Vehicles
- Class 8 Trucks/Trailers



[drphd.co](http://drphd.co)

888-399-6074

[Support@drpperformance.com](mailto:Support@drpperformance.com)



# **Get the Equipment You Want Now - Pay Over Time**

- Available for Any DRP Equipment Purchase Over \$2000.
- Simple Application • Decisions Typically in 24 hours
  - Business or Personal
- Pay Off Early and Save Interest - No Penalty

## **Traditional Financing Through DRP**

- 30% Deposit
- 12-60 Month Terms
- 3.99%-11.99% Rate
- First and Last Months Payment Due at Ship Date
- Payments Auto Billed to Credit/Debit Card
- Equipment is the Collateral. Customer agrees to return the equipment in the event of default.

## **Lease Financing Option Through DRP**

- 20% Deposit
- 24, 36, & 48 Month Terms
- \$1.00 Buy-Out at Lease End
- First and Last Months Payment Due at Ship Date
- Payments Auto Billed to Credit/Debit Card
- Return Option: After 1/2 of lease term, system may be returned at anytime and lease contract cancelled. System must be in good working order with only normal wear. Customer responsible for return freight.

## **100% Lease Financing Through 3rd Party**

- As little as 0% down
- Up to 60 month terms
- Lease/Purchase Options
- 3rd Party - DRP has no say in credit decision

Check out [DRPperformance.com](http://DRPperformance.com) for a complete system pricing, information & financing.  
E-mail [sales@drpperformance.com](mailto:sales@drpperformance.com) or call 888-399-6074 for more information.

Financing subject to credit approval. Terms are not guaranteed available and are subject to change.

### **The Fine Print:**

Terms from 90 days to 48 months available. Payment by check is accepted if received before the due date. If no payment received, payment will be auto billed to credit or debit card provided. Equipment financed is the collateral and must be returned in the event of any default. Declined payments will be charged \$30.00 late payment fee. Payments over 30 days past due will be in default. If payments are not made current within 45 days from due date, equipment must be returned, unless prior arrangements have been made in writing. Equipment may be returned at any time, in good working order and financing contract will be terminated. Principal balance may be paid at any time with no penalty. Down payment and 2 advanced payments (first and last months payment) due before shipment. Not available for purchases under \$2000.00. Only available for DRP equipment purchases (Pull Down Fixtures, Data Acquisition Systems, Alignment Systems, Rear End Fixtures, etc.). Items can be combined.

DRP Performance Products is a leader in low drag hub components and chassis set-up equipment for the racing industry. All of our products can be viewed online at [store.drpperformance.com](http://store.drpperformance.com) or by requesting a full catalog via phone or email.



## DRP Scalloped Tube Accessories

**Scalloped Tube Wrench**

- Dual end allows for quick and easy adjustments for 5/8" and 3/4" (see tube)
- Precision machined from sturdy, long-lasting aluminum
- Annealed for a stylish finish

\$39

**Lightweight Jam Nuts**

- Uses smaller wrench
- Lighter weight
- Thinner width allows for more adjustment

\$1.85 each

**Low Friction Rod Ends**

- DRP Premium Finished (Same process we use on our bearings)
- Dist. resistant
- No lube required

Available in all sizes

Contact for pricing. Rod ends starting at \$6.70

**Low Friction Rod End Reducers**

- DRP Premium Finished (Same process we use on our bearings)
- Built to order
- Great for 4 bar rods & lower arms

Contact for pricing

**3/4" Rod End Spacers**

3/4" x 1/4" Rod End Spacer - 007 51020  
3/4" x 1/2" Rod End Spacer - 007 51022  
3/4" x 3/4" Rod End Spacer - 007 51024

\$4.50 each

**5/8" Rod End Spacers**

5/8" x 1/4" Rod End Spacer - 007 51020  
5/8" x 1/2" Rod End Spacer - 007 51022  
5/8" x 3/4" Rod End Spacer - 007 51024

\$4.50 each

888-399-6074  
support@drpperformance.com  
www.drpperformance.com

## DRP Scalloped Spindle Nut

Our scalloped spindle nut is extremely lightweight and quick to use. The nuts lock automatically using a spring detent and grooved washer. No more looking on the ground for lost screws or trying to remove screws with rounded off heads.



Item Number	Description	Price
007 12600	Scalloped Spindle Nut	\$34.95
007 12601	Replacement Washer for Spindle Nut	\$8.85
007 12605	Scalloped Spindle Nut Socket	\$29.00

888-399-6074  
support@drpperformance.com  
www.drpperformance.com

## DRP Hub Defenders

Upgrade from Stock Hubs & Maximize Your Rig's Performance!  
**Improves Fuel Mileage  
Lower Maintenance  
Reduces Failures**

DRP Hub Defenders are a revolutionary product designed with heavy duty and high performance in mind. Our precision machined Hub Defenders will reduce bearing drag caused by bearing preload which will increase horse power and fuel economy. Our Hub Defenders protect your seals and bearings from failure effectively lowering maintenance costs.

- US Patent No. 6,312,162
- Adjusts to Fit Any Wheel Hub
- More Precision Replacement for Solid Bearing Spacers
- Converts Any Hub into a Precision "Low Drag" Hub
- Improves Bearing Life/Eliminates Spindle Wear
- Easily Adjusts to .001" End Play
- Lower Maintenance/Lower MPG/Better Alignment/Less Tire Wear



drphd.ca  
888-399-6074  
support@drpperformance.com

## Surface Plates



- Ships Via Motor Freight
- No Special Rigging
- Fast Set Up/No Special Tools
- 8" Wide x 12", 16" or 20" Long
- Leveling Screws Every 24"
- Great For Set Up Work, Body Mounting, Etc.
- 4" x 4" Plates Bolted Together on Grid Pattern with Flush Mount Bolts
- 3/8" Thick Plate on Top of 3/4" Thick Solid Steel Frame
- 2" x 2" Jack Pliers Standard
- Skirt Kit Optional

888-399-6074  
support@drpperformance.com  
www.drpperformance.com

## DRP High Performance Hub Components

More Horsepower to the Track!  
More Consistent Lap Times!

**DRP Wheel Bearing Spacers**

DRP Adjustable Wheel Bearing Spacers are easy to install and make an immediate difference you can feel. Bearing spacers set the bearing pre-load, preventing over tightening while reducing drag, simplifying maintenance, and increasing performance.

US Patent No. 6,312,162  
Available for all popular racing applications. Custom applications also available.

**DRP Premium Finished Bearings**

We take premium quality bearings and Premium finish the surface with our proprietary process to produce an ultra-low friction bearing. DRP Bearing Kits increase load\* free spin by 28% vs. standard import bearings and reduce temperature by over 100 degrees! Less drag than angular contact bearings under load.

Bearing kits available for most popular applications.  
Loaded testing performed on the DRP Hub Dyno. See website for more information.

**DRP Ultra Low Drag Hub Seals**

DRP ULD Hub Seals are custom built racing seals that incorporate a full PTFE sealing element and lightweight aluminum housing. Reusable design lasts through multiple uses. Ultra Low Drag Seals available for most popular applications.

**Ultra Low Drag Wheel Bearing Greases**

This is the best wheel bearing grease we have tested, period. Over 70% increase in free spin versus most popular greases. Available in 396 gram cartridges and one liter 16.9 oz. syringes. One syringe will pack approximately 18 bearings 50% full. Do not over-pack wheel bearings and use it to remove friction and drag. Inject grease to fill cavity between every other roller. Repack bearings every 1,000-1,500 laps for optimum performance.

888-399-6074  
www.drpperformance.com  
support@drpperformance.com

"...let us run with endurance the race that is set before us..." Hebrews 12:1

## DRP Legends Car Products

DRP offers a Legends Front Seal in Standard PTFE or Air Cap. Benefits include:

- Low Drag & Rotating Weight
- Increase Hub Free Spin
- Lightweight Aluminum Housing

Legends Front Air ULD Seal 007 10575 \$24  
Legends Front Air ULD Seal 007 10575 \$24  
Legends Front Seal 007 10575 \$24

Our DRP Premium Bearing Kits go through a 6+ hour Premium Finishing Process which:

- Low Drag & Rotating Weight
- Increase Hub Free Spin
- Lightweight Aluminum Housing

Legends Front Bearing Kit 007 10575 \$24  
Legends Front Bearing Kit 007 10575 \$24  
Legends Front Bearing Kit 007 10575 \$24

DRP Patented Adjustable Bearing Spacers make the most difference in all of our low drag hub components. Our spacers will:

- Increase Hub Free Spin
- Increase Corner Speed
- Reduce Drag

Legends Front Bearing Spacer 007 10575 \$24



Suspension Analysis  
Low Drag Hub Components  
Specialty Products

2020 Master Catalog

"...let us run with endurance the race that is set before us..." Hebrews 12:1

888-399-6074

drpperformance.com

